

SAFE-GUARD TERMITE & PEST CONTROL, INC.
194 SOUTH CANAL STREET
YARDLEY, PA. 19067
215-493-7770 (office) 215-321-4517 (fax)

March 2, 2005

TERRY W. CLEMENS & ASSOCIATES
DONNA LEE
107 E. OAKLAND AVENUE
DOYLESTOWN, PA 18901

Service Property:

2101 STREET ROAD
New Hope, PA 18938

To Whomever It May Concern;

A visual inspection of the above referenced property found evidence of wood destroying insects.

Areas are indicated on the attached NPCA-1 graph.

In order to issue the requested NPCA-1 report it would be necessary to treat the property. Our fee of \$675.00 includes treatment, tax and one year renewable warranty at \$75.00 each year.

If you have any questions or need additional information do not hesitate to contact me at the above number.

Sincerely,

George Erskine
WDI INSPECTION DEPT.

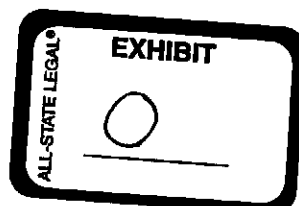

REAL ESTATE INSPECTION DISCLOSURE ATTACHMENT TO FORM NPCA-1

The infestation and/or damage depicted represents only that evidence that was visible at the time of the inspection in the general areas indicated. When evidence of wood destroying insects is found it should be understood that some degree of damage including hidden damage may be present damage in the structure. Many buildings have hidden termite infestation/damage that competently performed wood destroying inspection may not disclose. Therefore, the decisions to dismantle (or remove ceilings, finished walls, carpets, etc.) and to what extent dismantling is to be done, must be made by the involved parties (buyers, buyers building contractor, seller, seller's contractor, etc.). Needless to say, the cost and responsibility of restoring disturbed finished walls, ceilings, carpets, etc. must be discussed by these parties. Reported signs of infestation in a building make the decision even more critical. Due to Icryptobioticior hidden mode of life of subterranean (the most common species) termites, they often do more damage in hidden areas than in exposed areas. Their survival requires that they avoid sunlight and low moisture environments. It is important to understand that the Inspection Company will not make a specific recommendation regarding opening of walls, ceilings, etc. Removal of carpets and/or dismantling of any kind.

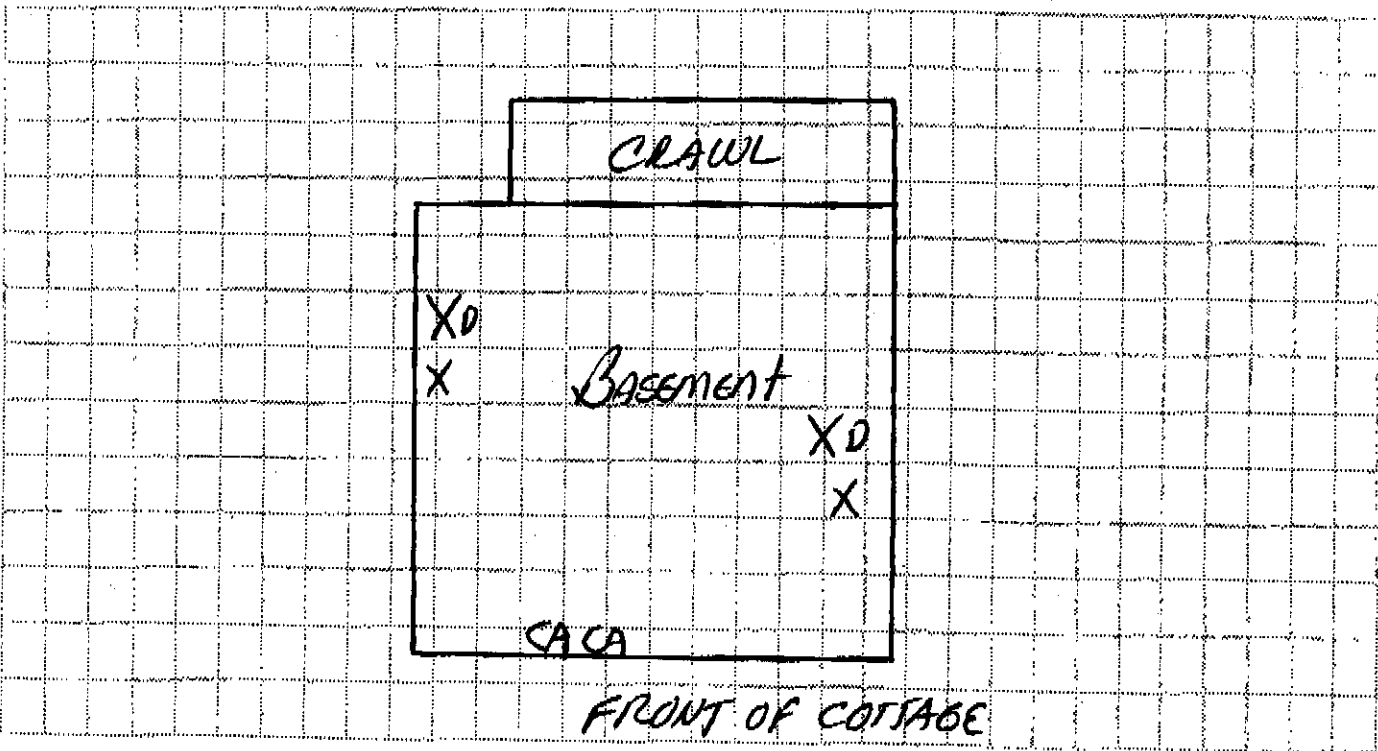

The findings depicted illustrate general areas of the structures lowest level unless specifically noted. The drawing is not to scale.
Symbols: X = Visible signs of infestation by termites CB = Carpenter Bee CA = Carpenter Ant OH = Old house borer
PB = Powder post beetle OT = Other, Explain: _____
D = Visible signs of damage by wood destroying insects

COMMENTS: TERMITE SHELTER TUBES AND DAMAGE AT TWO FLOOR JOISTS.

MAIN HOUSE IS CLEAR...

Inspection Address: 2101 STREET ROAD NEWHOPE (COTTAGE) Date: 3-2-05
Attachments: _____ Inspector's Initials: WM

The training and experience specified to wood destroying insect inspection do not qualify the inspector in damage evaluation or any other building/construction technology and/or repair. Accordingly, the inspection/inspection company is not responsible for repair of damage except as may be provided by separate contract. The inspector may find wood which has been damaged by insects. Any damage noted should be considered only as evidence of wood destroying insects and should not be considered a report as to the extent of damage. The signs of wood destroying insects depicted do not necessarily include all areas of infestation and/or damage from wood destroying insects which may exist as of the date of the inspection. The buyer and/or his qualified building contractor should examine the structure to determine the extent of damage and need of repair. This information is provided for the buyer as part of the seller's and/or agent's disclosure of defects. This diagram is part of the inspection report attached and the information herein is provided within the same context and subject to the same limitations spelled out in the Wood Destroying Insect Inspection Report Form NPCA-1.

CUSTOMER SIGNATURE _____