

BARN, GARAGES & STORAGE BUILDINGS

The barn was built around 1850 and contains 2,600± square feet. Basic construction is stone and frame exterior walls, slate roof and galvanized metal gutters and downspouts. The lower level has a foaling shed with two stalls and concrete flooring. The main structure has three stalls with concrete flooring on the first level and a ladder that provides access to the hayloft above. Finish is minimal. Overall condition is average. Utility is also average.

The barn/garage building is of unknown age and contains 1,928± square feet. Basic construction is stucco and frame exterior walls, slate roof and galvanized metal gutters and downspouts. The lower level has concrete flooring with four (4) overhead doors. There is a ladder that provides access to the second level hayloft. Finish is minimal. Overall condition is average. Utility is also average.

Garage #1 is of unknown age and contains 2,388± square feet. Basic construction is stucco exterior walls, slate and metal roofing and aluminum gutters and downspouts. The main portion has two overhead doors and concrete flooring. There is oil-fired hot air heating servicing this area. Ceiling heights are 12 feet high with acoustic panel ceilings noted. The rear portion is a mechanical room which houses the heating system. Overall condition is average. Utility is also average.

Garage #2 is of unknown age and contains 950± square feet. Basic construction is wood frame exterior walls, metal roof and galvanized gutters and downspouts. There are three overhead doors and concrete flooring. Overall condition is average. Utility is also average.

The shop building was built around 1850 and contains 540 square feet. Basic construction is wood frame exterior walls, slate roof and no gutters and downspouts. The interior has minimal finish with concrete flooring on the first level and wood flooring on the second level. Overall condition is average. Utility is also average.

The lean-to was built around 1850 and contains 732± square feet. Basic construction is stone exterior walls, cedar shake roof and no gutters or downspouts. This structure has two separate bays with gravel flooring but doors. The greenhouse portion has stone flooring. Finish is minimal. Overall condition is average. Utility is also average.

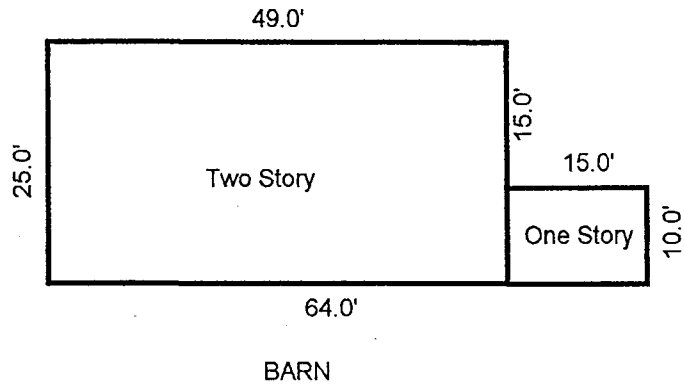

Scale: 1 = 20

| AREA CALCULATIONS SUMMARY | | | |
|---------------------------|--------------|---------|------------|
| Code | Description | Size | Net Totals |
| GBA1 | First Floor | 1375.00 | 1375.00 |
| GBA2 | Second Floor | 1225.00 | 1225.00 |
| TOTAL BUILDING (rounded) | | | 2600 |

| BUILDING AREA BREAKDOWN | | |
|--------------------------------|-------------|-----------|
| | Breakdown | Subtotals |
| First Floor | | |
| | 25.0 x 49.0 | 1225.00 |
| | 10.0 x 15.0 | 150.00 |
| Second Floor | | |
| | 25.0 x 49.0 | 1225.00 |
| 3 Calculations Total (rounded) | | 2600 |

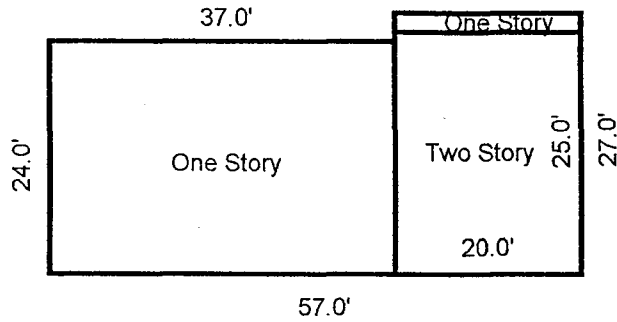

BARN/GARAGE

Scale: 1 = 20

| AREA CALCULATIONS SUMMARY | | | |
|---------------------------|--------------|---------|------------|
| Code | Description | Size | Net Totals |
| GBA1 | First Floor | 1388.00 | 1388.00 |
| GBA2 | Second Floor | 540.00 | 540.00 |
| TOTAL BUILDING (rounded) | | | 1928 |

| BUILDING AREA BREAKDOWN | | |
|--------------------------------|--------|-----------|
| Breakdown | | Subtotals |
| First Floor | | |
| 24.0 | x 57.0 | 1388.00 |
| 1.0 | x 20.0 | 20.00 |
| Second Floor | | |
| 20.0 | x 27.0 | 540.00 |
| 3 Calculations Total (rounded) | | 1928 |

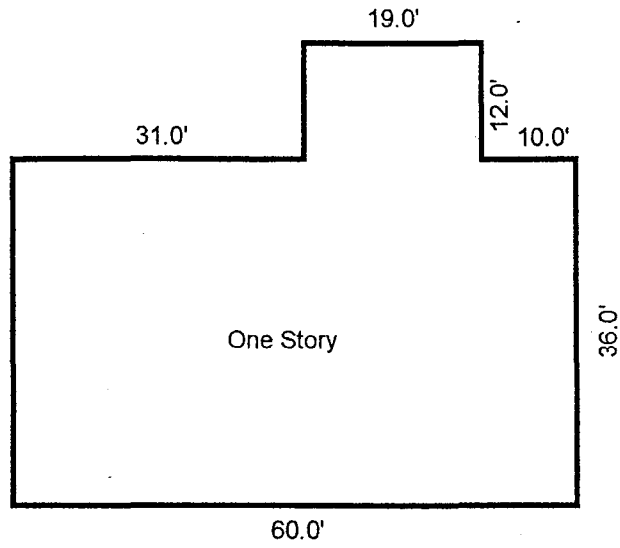

60.0'
One Story
36.0'
GARAGE 1

Scale: 1 = 20

| AREA CALCULATIONS SUMMARY | | | |
|---------------------------|-------------|---------|------------|
| Code | Description | Size | Net Totals |
| GBA1 | First Floor | 2388.00 | 2388.00 |
| TOTAL BUILDING (rounded) | | | 2388 |

| BUILDING AREA BREAKDOWN | | | |
|--------------------------------|---|------|-----------|
| Breakdown | | | Subtotals |
| First Floor | | | |
| 12.0 | x | 19.0 | 228.00 |
| 36.0 | x | 60.0 | 2160.00 |
| 2 Calculations Total (rounded) | | | 2388 |

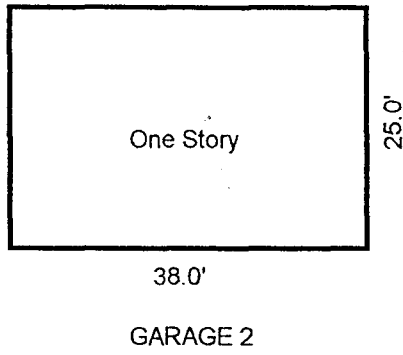

Scale: 1 = 20

| AREA CALCULATIONS SUMMARY | | | |
|---------------------------------|-------------|--------|------------|
| Code | Description | Size | Net Totals |
| GBA1 | First Floor | 950.00 | 950.00 |
| TOTAL BUILDING (rounded) | | | 950 |

| BUILDING AREA BREAKDOWN | | |
|--------------------------------------|------------|--|
| Breakdown | Subtotals | |
| First Floor | 950.00 | |
| 25.0 x 38.0 | | |
| 1 Calculation Total (rounded) | 950 | |

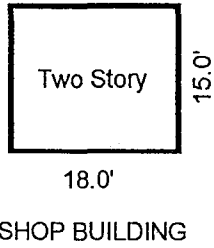

Scale: 1 = 20

| AREA CALCULATIONS SUMMARY | | | |
|---------------------------------|--------------|--------|------------|
| Code | Description | Size | Net Totals |
| GBA1 | First Floor | 270.00 | 270.00 |
| GBA2 | Second Floor | 270.00 | 270.00 |
| TOTAL BUILDING (rounded) | | | 540 |

| BUILDING AREA BREAKDOWN | | |
|---------------------------------------|--------|------------|
| Breakdown | | Subtotals |
| First Floor | | |
| 15.0 | x 18.0 | 270.00 |
| Second Floor | | |
| 15.0 | x 18.0 | 270.00 |
| 2 Calculations Total (rounded) | | 540 |

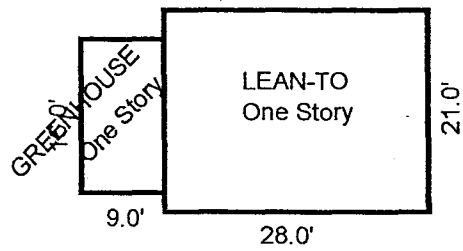

Scale:

| AREA CALCULATIONS SUMMARY | | | |
|---------------------------|-------------|--------|------------|
| Code | Description | Size | Net Totals |
| GBA1 | Lean-To | 588.00 | 732.00 |
| | Greenhouse | 144.00 | |
| TOTAL BUILDING (rounded) | | | 732 |

| BUILDING AREA BREAKDOWN | | | |
|--------------------------------|------|--------|-----------|
| Breakdown | | | Subtotals |
| Lean-To | 21.0 | x 28.0 | 588.00 |
| Greenhouse | 9.0 | x 16.0 | 144.00 |
| 2 Calculations Total (rounded) | | | 732 |