

CHARMING COTTAGE

The cottage was built around 1930 and contains 1,124± square feet. Basic construction is wood frame exterior walls, slate roof and galvanized metal gutters and downspouts. The basement has stone foundation walls and concrete flooring. This area houses the oil-fired hot water heating system, one (1) 275-gallon oil tank, sump pump and 100 ampere electrical service. The first level includes a vestibule, living room, kitchen and den. The second level includes a bedroom and full bathroom. The structure requires renovation but has many period architectural features. Overall utility is average.

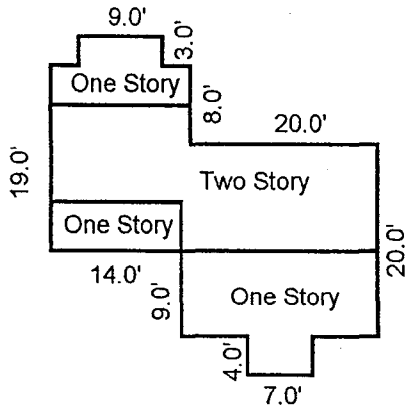

Cottage

Scale: 1 = 20

AREA CALCULATIONS SUMMARY			
Code	Description	Size	Net Totals
GLA1	First Floor	749.00	749.00
GLA2	Second Floor	375.00	375.00
TOTAL LIVABLE (rounded)			1124

LIVING AREA BREAKDOWN			
Breakdown			Subtotals
First Floor			
4.0	x	7.0	28.00
3.0	x	9.0	27.00
20.0	x	21.0	420.00
1.0	x	8.0	8.00
14.0	x	19.0	266.00
Second Floor			
11.0	x	21.0	231.00
1.0	x	4.0	4.00
10.0	x	14.0	140.00
8 Calculations Total (rounded)			1124