

## FARMHOUSE

The farmhouse dwelling was built around 1962 and contains 4,270± square feet of gross living area. Basic construction is stone and stucco exterior walls, slate roof and aluminum gutters and downspouts. The basement has poured concrete foundation walls, concrete flooring and an outside exit. This area houses the oil-fired hot air heating system with central air conditioning, two (2) 275 gallon oil tanks, three-phase electrical service, and well tank. The first level includes a living room with fireplace, built-in bookcases, crown molding and chairrail; dining room with window seat in box window, crown molding and chairrail; kitchen with wood base and wall cabinets, marble and ceramic tile countertops, porcelain drainboard and sink, four burner electric range, wall oven, ceramic tile flooring, fireplace and beamed ceiling; den with wood panel walls, fireplace and built-in bookcases; master bedroom with fireplace; master bathroom with ceramic tile shower over tub and hardwood flooring; and laundry room with built-in cabinetry. The second level has four bedrooms and two full bathrooms. There is a walk-up, floored attic used for storage. Generally, interior finish is hardwood flooring, plaster walls and plaster or acoustic panel ceilings. Overall condition is average. Overall utility is good.

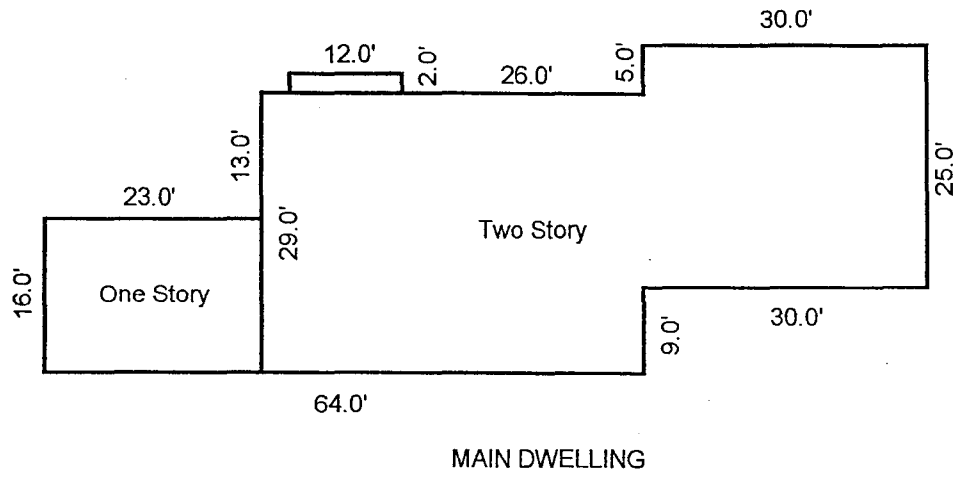

Scale: 1 = 20

AREA CALCULATIONS SUMMARY			
Code	Description	Size	Net Totals
GLA1	First Floor	2331.00	2331.00
GLA2	Second Floor	1939.00	1939.00
<b>TOTAL LIVABLE (rounded)</b>			<b>4270</b>

LIVING AREA BREAKDOWN		
Breakdown		Subtotals
<b>First Floor</b>		
25.0	x 30.0	750.00
2.0	x 12.0	24.00
16.0	x 64.0	1024.00
13.0	x 41.0	533.00
<b>Second Floor</b>		
25.0	x 30.0	750.00
29.0	x 41.0	1189.00
<b>6 Calculations Total (rounded)</b>		<b>4270</b>