

VICTORIAN HOUSE

The Victorian dwelling was built around 1850 and contains 4,494± square foot. Basic construction is wood frame exterior walls, slate roof and copper gutters and downspouts. The basement has stone foundation walls, concrete flooring and outside exits. This area houses the oil-fired heating system. The structure is currently divided into two units. The front unit was used for a nonresidential use and includes a center hallway, living room, double parlor, den and full bathroom on the first level. There are four bedrooms on the second level. This portion has high ceilings and period moldings with fine architectural features; however, it is in need of renovation. The rear unit has a semi-modern kitchen on the first level. There is a sitting room, two bedrooms and a full bathroom on the second level. This unit does not possess the same architectural details as the first; it does require complete renovation. Overall utility is average.

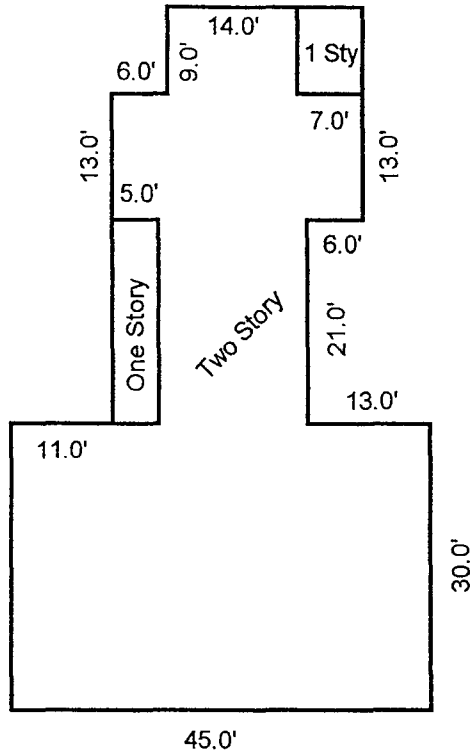

VICTORIAN DWELLING

Scale: 1 = 20

AREA CALCULATIONS SUMMARY			
Code	Description	Size	Net Totals
GLA1	First Floor	2331.00	2331.00
GLA2	Second Floor	2163.00	2163.00
TOTAL LIVABLE (rounded)			4494

LIVING AREA BREAKDOWN			
Breakdown			Subtotals
First Floor			
21.0	x	22.0	462.00
15.0	x	21.0	315.00
6.0	x	34.0	204.00
30.0	x	45.0	1350.00
Second Floor			
9.0	x	14.0	126.00
13.0	x	27.0	351.00
16.0	x	21.0	336.00
30.0	x	45.0	1350.00
8 Calculations Total (rounded)			4494