



REAL ESTATE AUCTION

To Be Sold for Haverford Township
Residential Tract for 2 Homes to Be Built



AUCTION
Build 2 Homes



For rehab or tear down

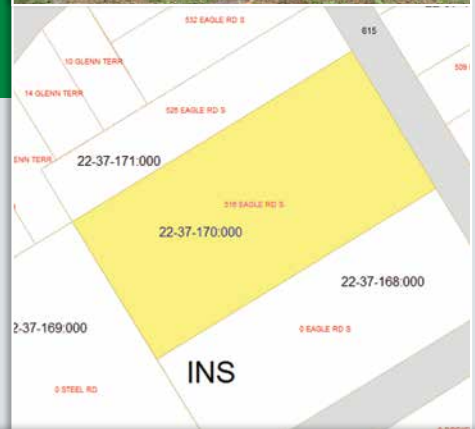

Watch for Auction Date and Auction Location to be announced in your email from Traiman.

Walk the land at your own risk.

516 South Eagle Road, Havertown, Delaware County, PA
Early Schoolhouse may be demolished or rehabbed

Guaranteed Deposit: A good faith registration deposit in the form of a \$20,000 Bank Cashier's Check (made payable to yourself) is required to register to bid at the time of the Auction and will be credited towards the 20% Deposit. The balance of the deposit may be paid by personal check. Remember to bring both the Bank Cashiers Check and a personal check.

For more property information, including agreement of sale and auction terms, visit traiman.com or call 215-799-0655.

527 Plymouth Rd, Suite 414
Plymouth Meeting PA 19462



Founded 1924 Philadelphia, PA

WWW.TRAIMAN.COM | 215.799.0655

RETURN ADDRESS

TAC - PRINTING SERVICES
103 SALFORD WAY
TELFORD, PA 18969-1541

FIRST CLASS MAIL
US POSTAGE
PAID
PERMIT #164
PHILA. PA



215-799-0655 | fax 215-799-0656 | PA_AY000040L | NJ 7837064
Douglas Clemens, Chairman & CEO

For more information go to www.traiman.com
To be notified of upcoming Auctions go to traiman.com/sign-up.

REAL ESTATE AUCTION

Residential Tract for 2 Homes to Be Built

**516 South Eagle Road, Havertown
Delaware County, PA**

NOTICE: The information used for the advertising of this property may not be accurate. Measurements, figures, and drawings are approximate. Interested parties must do their own research and are not to rely on any information provided by the seller, the auction company, or their representatives. The Agreement of Sale takes precedence over any advertising or oral or written announcements. Auctioneer represents the Seller, not the Buyer. Subject to good and marketable title. Auctioneer reserves the right to reject bids that the auctioneer deems inadequate. If you have a question during the auction, please notify an auction staff member for a private conversation. Seller and the Auction Company reserve the right to have parties escorted from the premises for soliciting other bidders or for other reasons deemed inappropriate. Information contained herein is subject to change. Property is subject to being withdrawn and being Sold prior to the Public Auction.

REAL ESTATE AUCTION



**AUCTION
Build 2 Homes**

**To Be Sold for
Haverford Township**

**Residential Tract for
2 Homes to Be Built
516 South Eagle Road,
Havertown,
Delaware County, PA**

**Early Schoolhouse may be
demolished or rehabbed**

**Watch for Auction Date
and Auction Location to
be announced in your
email from Traiman.**



America's Foremost Auction Company | Founded 1924 Philadelphia, PA
Premier Properties | Commercial | Residential | Land | Farms | Industrial | New Construction
Resorts | Golf Courses | Marinas | Trusts & Decedents' Estates | Businesses | Condos

WWW.TRAIMAN.COM | 215.799.0655